



HEMMINGS HOMES

OFFERS OVER

£115,000

Lomond Drive

Wishaw, ML2 0NR

PROPERTY SUMMARY

CLOSING DATE THURSDAY 25TH APRIL 12PM

Are you looking for a be a stunning 3 bedroom end-terraced family home which has been upgraded both internally and externally located in the popular locale of Wishaw?

Hemmings Homes are delighted to offer to the market a generously sized and totally upgraded 3 bedroom family home which is in show home condition throughout.

The main entrance to the front of the property opens onto a welcoming hallway, a beautiful front facing lounge, a fantastic contemporary, fitted kitchen with integrated appliances and fantastic storage.

On the upper level you will find a fantastic family bathroom with shower over the bath and 3well proportioned bedrooms. 2 with built in storage.

Externally you will find an enclosed paved front garden, a large driveway offering off street parking for several vehicles and a stunning, landscaped rear garden with open outlook.

3



1



1





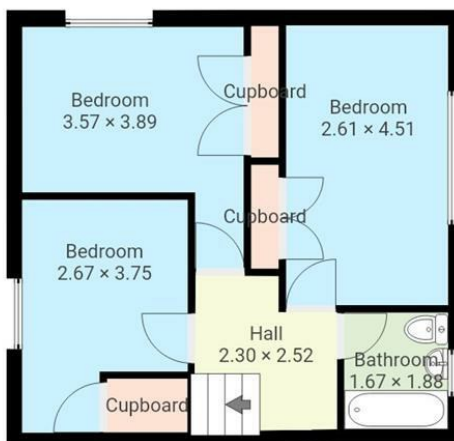

LOCAL AUTHORITY
North Lanarkshire Council

TENURE
Freehold

COUNCIL TAX BAND
B

VIEWINGS
By prior appointment only

| Energy Efficiency Rating | | |
|---|---------|-------------------------|
| | Current | Potential |
| Very energy efficient - lower running costs | | |
| (92 plus) A | 70 | 84 |
| (81-91) B | | |
| (69-80) C | | |
| (55-68) D | | |
| (39-54) E | | |
| (21-38) F | | |
| (1-20) G | | |
| Not energy efficient - higher running costs | | |
| Scotland | | EU Directive 2002/91/EC |

Whilst every attempt has been made to ensure the accuracy of the floor plan contained here, measurements of doors, windows, rooms and any other items are approximate and no responsibility is taken for any error omission or mis-statement. This plan is for illustrative purposes only and should be used as such by any prospective purchaser.

Agents Note: Whilst every care has been taken to prepare these particulars, they are for guidance purposes only. All measurements are approximate and are for general guidance purposes only and whilst every care has been taken to ensure their accuracy, they should not be relied upon and potential buyers/tenants are advised to recheck the measurements



OFFICE ADDRESS
376 Brandon Street
Motherwell
North Lanarkshire
ML1 1XA

OFFICE DETAILS
01698 263413
enquiries@hemmingshomes.co.uk
hemmingshomes.co.uk